

ORDINANCE NO. 301

AN ORDINANCE PROVIDING FOR THE VOLUNTARY ANNEXATION OF CERTAIN LANDS ADJACENT TO THE SOUTH BOUNDARY OF THE CITY LIMITS, IN SECTION 19, TOWNSHIP 8 SOUTH, RANGE 10 WEST, GULF COUNTY, FLORIDA; PROVIDING A DESCRIPTION OF THE LANDS TO BE ANNEXED; PROVIDING FOR THE REDEFINING OF CITY BOUNDARIES TO INCLUDE SAID LANDS; PROVIDING FOR SEVERABILITY AND PROVIDING FOR AN EFFECTIVE DATE

WHEREAS, the owner of the lands described in Exhibit "B", pursuant to §171.044, Florida Statutes, has voluntarily petitioned the City of Port St. Joe to annex the lands described in Exhibit "B", and

WHEREAS, a copy of the Public Notice to consider this ordinance for final adoption was provided to the Board of County Commissioners of Gulf County, Florida, and

WHEREAS, the City of Port St. Joe has caused to be published a notice, together with a map showing the area sought to be annexed, which notice is attached to this ordinance, and

WHEREAS, the City Commissioners of the City of Port St. Joe have ascertained that it is in the best interests of the City of Port St. Joe to annex said lands; now, therefore,

**BE IT ENACTED BY THE PEOPLE OF THE CITY OF PORT ST. JOE, FLORIDA:**

1. The City does hereby annex the lands described in Exhibit "B" attached hereto;
2. The city boundaries shall be amended and redefined to include the lands to be annexed which are described in Exhibit "B" attached hereto;
3. REPEAL: All ordinances or parts of ordinances in conflict herewith are hereby repealed.
4. EFFECTIVE DATE: This ordinance shall become effective upon adoption as provided by law.

THIS ORDINANCE ADOPTED this 18th day of February, 2003.

BOARD OF CITY COMMISSIONERS  
PORT ST. JOE, FLORIDA

  
\_\_\_\_\_  
Mayor-Commissioner

ATTEST:

  
\_\_\_\_\_  
City Clerk

**EXHIBIT "B"**

**Legal Description**

**All that part of the West Half of Section 19, Township 8 South, Range 10 West, Gulf County, Florida, that lies South of Highway 98, West of Depot Creek and North of the SW  $\frac{1}{4}$  of SW  $\frac{1}{4}$ .**

Proposed '15

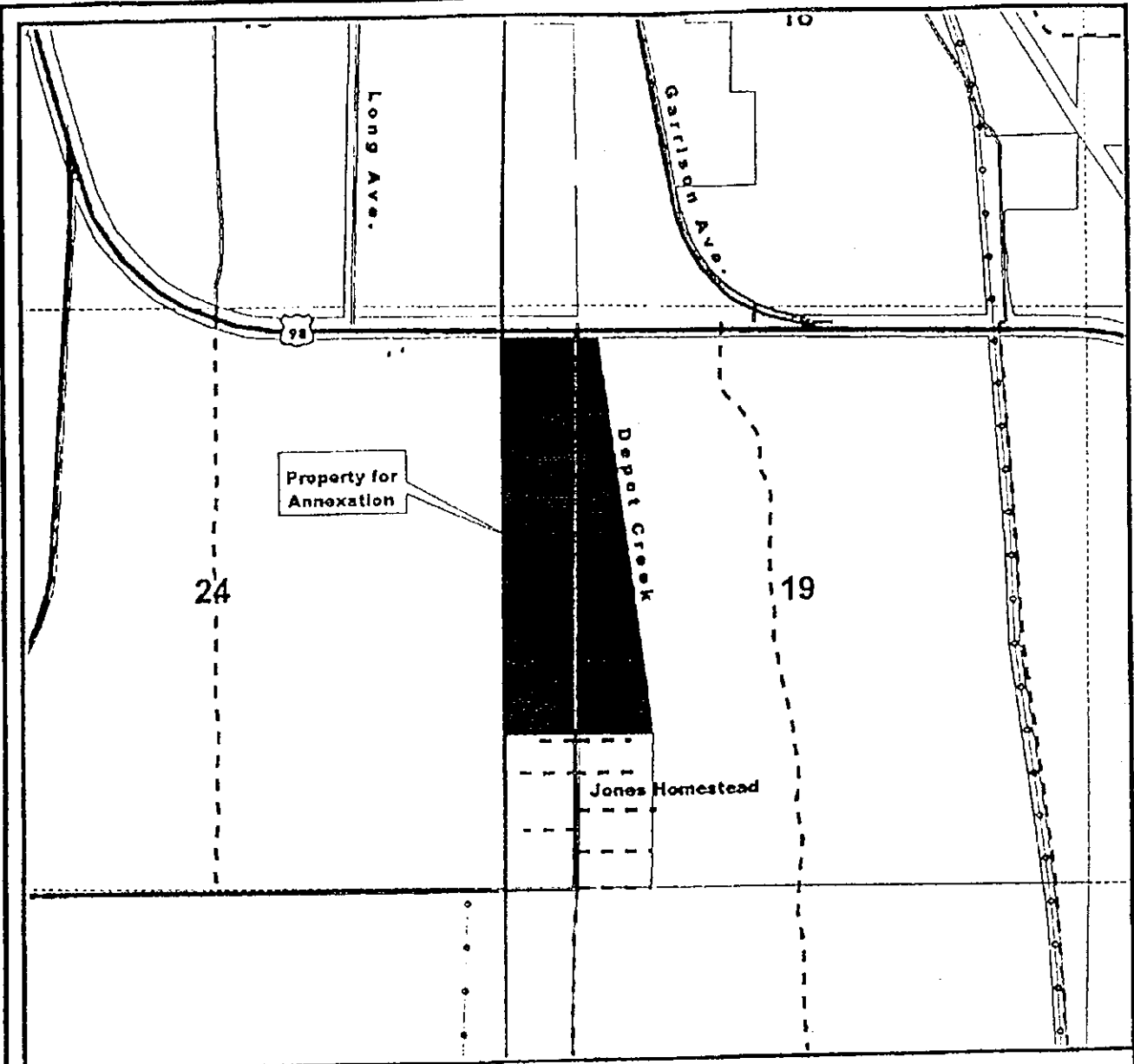

### Jones Homestead Annexation

94 +/- Acres in Section 19 of T8S, R10W Gulf County, Florida

- Property for Annexation
- Other St. Joe Property

The information shown, attached or contained herein is believed accurate but is not warranted or guaranteed, is subject to errors, omissions and changes without notice and should be independently verified. The availability and pricing of St. Joe Company property (through any of its affiliates or subsidiaries) is also subject to change without notice. Access to this property is prohibited without the express consent of St. Joe Land Company or its agent.

This drawing is the property of St. Joe Land Company. Unless otherwise provided for by Contract, the contents of this drawing are confidential and shall not be transmitted to any other party except as agreed to by St. Joe Land Company. It may not be copied or reproduced in any manner without the written permission of St. Joe Land Company. "ST. JOE" and the "Taking Flight" design are registered service marks of The St. Joe Company.

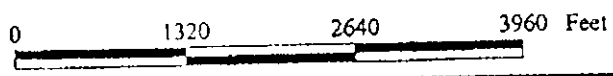

1/7/03

Prepared by Tom W. Suhr  
St. Joe Land Company GIS