

**ORDINANCE NO. :439**

**AN ORDINANCE OF THE CITY OF PORT ST. JOE, FLORIDA, AMENDING THE COMPREHENSIVE PLAN AND FUTURE LAND USE MAP OF THE CITY OF PORT ST. JOE, BY AND THROUGH THE PROCEDURES REQUIRED FOR LARGE SCALE MAP AMENDMENTS PURSUANT TO AUTHORITY PROVIDED BY FLORIDA STATUTES SPECIFICALLY CHANGING ALL OR PART OF PARCEL 03039-000, BEING 13.36 ACRES FROM COUNTY AGRICULTURAL TO CONSERVATION; PROVIDING FOR REPEAL OF ANY CONFLICTING ORDINANCE; PROVIDING FOR SEVERABILITY; AND PROVIDING AN EFFECTIVE DATE.**

BE IT ENACTED BY THE PEOPLE OF THE CITY OF PORT ST JOE, FLORIDA:

**SECTION 1. APPROVAL:**

The application for amendment to the Future Land Use Map for the property described in Composite Exhibit "A" is approved and the land use designation is hereby changed to **Conservation**.

**SECTION 2. CONSISTENCY WITH THE CITY OF PORT ST. JOE COMPREHENSIVE PLAN:**

The Board of City Commissioners hereby finds and determines that the approval of the application and change in land use as set forth in Section 1 is consistent with the goals, objectives and policies of the City of Port St. Joe Comprehensive Plan.

**SECTION 3. ENFORCEMENT:**

The City may enforce this Ordinance as authorized by law.

**SECTION 4. FUTURE LAND USE MAP:**

Upon this Ordinance becoming effective, the City of Port St. Joe Future Land Use Map shall be amended to show the Property as having a land use of **Conservation**. The City Manager is hereby directed to revise the City of Port St. Joe Future Land Use Map to reflect this designation.

**SECTION 5. REPEAL:**

All ordinances or parts of Ordinances in conflict herewith are hereby repealed.

**SECTION 6. SEVERABILITY:**

The provisions of this Ordinance are hereby declared to be severable. If any provision of this Ordinance, or the application thereof, to any person or circumstance is held to be invalid, such invalidity shall not effect other provisions or applications of this Ordinance that can be given effect without the invalid provision or application.

**SECTION 7. EFFECTIVE DATE:**

This Ordinance shall become effective upon approval of the future land use map change described above.

16<sup>th</sup> This Ordinance was adopted in regular meeting after its second reading this day of March, 2010.

**THE CITY OF PORT ST. JOE BOARD  
OF CITY COMMISSIONERS**

  
\_\_\_\_\_  
Mayor

Attest :

  
\_\_\_\_\_  
City Manager

COMPOSITE EXHIBIT "A"

## EXHIBIT "A"

### SURVEY DESCRIPTION:

A parcel of land being a portion of the West half of the West half of the Southwest quarter of Section 18, Township 8 south, Range 10 West and a portion of the Southeast quarter and the Northeast quarter of Fractional Section 13, Township 8 South, Range 11 West, Gulf County, Florida, being more particularly described as follows:

Commence at a 3 inch round concrete monument marking the Northeast corner of Fractional Section 13, Township 8 South, Range 11 West, and the Northwest corner of Section 18, Township 8 South, Range 10 West, Gulf County, Florida; thence South 01 degrees 15 minutes 32 seconds West along the West line of said Section 18 for a distance of 2077.61 feet to a St. Joe Paper Company (S.J.P.C.) concrete monument and the Point of Beginning; thence continue South 01 degrees 17 minutes 06 seconds West along the West line of said Section 18 for a distance of 534.21 feet to a St. Joe Paper Company (S.J.P.C.) concrete monument marking the Northwest corner of the Southwest quarter of said Section 18; thence South 88 degrees 59 minutes 12 seconds East along the North line of the Southwest quarter of said Section 18 for a distance of 660.00 feet to a St. Joe Paper Company (S.J.P.C.) concrete monument marking the Northwest corner of the Gulf Coast Community College parcel as described in the Instrument recorded in Official Records Book 275, Page(s) 179 of the Official Records of Gulf County, Florida; thence South 01 degrees 13 minutes 00 seconds West along the West line of said Gulf Coast Community College parcel for a distance of 976.41 feet; thence South 80 degrees 46 minutes 06 seconds West for a distance of 922.69 feet; thence North 01 degrees 46 minutes 23 seconds East for a distance of 604.93 feet; thence North 87 degrees 07 minutes 41 seconds West for a distance of 200.32 feet; thence North 01 degrees 53 minutes 45 seconds West for a distance of 560.75 feet; thence North 87 degrees 34 minutes 55 seconds West for a distance of 240.35 feet to a St. Joe Paper Company (S.J.P.C.) concrete monument; thence North 01 degrees 15 minutes 56 seconds East for a distance of 499.58 feet to a St. Joe Paper Company (S.J.P.C.) concrete monument; thence South 88 degrees 48 minutes 48 seconds East for a distance of 712.70 feet to the Point of Beginning,

LESS AND EXCEPT:

**SURVEY DESCRIPTION:**

A parcel of land being a portion of the West half of the West half of the Southwest quarter of Section 18, Township 8 south, Range 10 West and a portion of the Southeast quarter and the Northeast quarter of Fractional Section 13, Township 8 South, Range 11 West, Gulf County, Florida, being more particularly described as follows:

Commence at a 3 inch round concrete monument marking the Northeast corner of Fractional Section 13, Township 8 South, Range 11 West, and the Northwest corner of Section 18, Township 8 South, Range 10 West, Gulf County, Florida; thence South 01 degrees 15 minutes 32 seconds West along the West line of said Section 18 for a distance of 2077.61 feet to a St. Joe Paper Company (S.J.P.C.) concrete monument and the Point of Beginning; thence continue South 01 degrees 17 minutes 06 seconds West along the West line of said Section 18 for a distance of 534.21 feet to a St. Joe Paper Company (S.J.P.C.) concrete monument marking the Northwest corner of the Southwest quarter of said Section 18; thence continue South 01 degrees 13 minutes 00 seconds West along the West line of said Section 18 for a distance of 162.51 feet; thence South 13 degrees 54 minutes 57 seconds East for a distance of 920.86 feet; thence South 80 degrees 46 minutes 06 seconds West for a distance of 496.01 feet; thence North 01 degrees 46 minutes 23 seconds East for a distance of 604.93 feet; thence North 87 degrees 07 minutes 41 seconds West for a distance of 200.32 feet; thence North 01 degrees 53 minutes 45 seconds West for a distance of 560.75 feet; thence North 87 degrees 34 minutes 55 seconds West for a distance of 240.35 feet to a St. Joe Paper Company (S.J.P.C.) concrete monument; thence North 01 degrees 15 minutes 56 seconds East for a distance of 499.58 feet to a St. Joe Paper Company (S.J.P.C.) concrete monument; thence South 88 degrees 48 minutes 48 seconds East for a distance of 712.70 feet to the Point of Beginning,

# EXHIBIT A

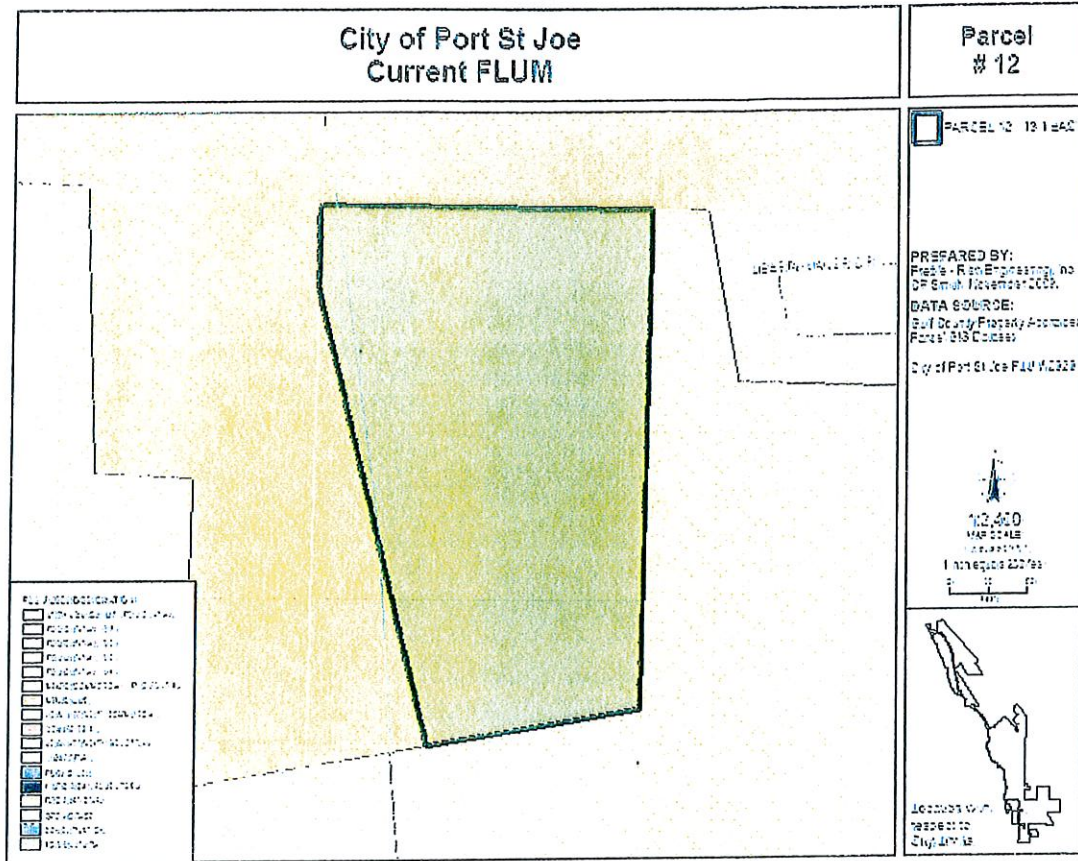

# EXHIBIT B

